

## 200 V - 1,000 V Single Phase Bridge

22.0 A - 25.0 A Forward Current

70 ns - 3000 ns Recovery Time

**1502B - 1510B**  
**1502FB - 1510FB**  
**1502UFB - 1510UFB**

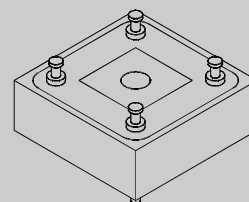

### ELECTRICAL CHARACTERISTICS AND MAXIMUM RATINGS

| Part Number | Working Reverse Voltage<br>(V <sub>rw</sub> ) | Average Rectified Current @TC<br>(I <sub>o</sub> ) |       | Reverse Current @ V <sub>rw</sub> m<br>(I <sub>r</sub> ) |       | Forward Voltage<br>(V <sub>f</sub> ) |      | 1 Cycle Surge Current<br>t <sub>p</sub> =8.3ms<br>(I <sub>fsm</sub> ) | Repetitive Surge Current<br>(I <sub>frm</sub> ) | Reverse Recovery Time<br>(1)<br>(T <sub>rr</sub> ) | Thermal Impd.<br><br>θ <sub>J-C</sub> |
|-------------|---|--|-------|--|-------|--------------------------------------|------|---|---|--|---------------------------------------|
|             |   | 55°C   | 100°C | 25°C   | 100°C | 25°C                                 |      | 25°C  | 25°C  | 25°C   |                                       |
|             | Volts   | Amps   | Amps  | μA   | μA    | Volts                                | Amps | Amps  | Amps  | ns   | °C/W                                  |
| 1502B       | 200   | 25.0   | 18.0  | 1.0  | 25    | 1.1                                  | 3.0  | 150   | 25  | 3000   | 2.0                                   |
| 1506B       | 600   | 25.0   | 18.0  | 1.0  | 25    | 1.1                                  | 3.0  | 150   | 25  | 3000   | 2.0                                   |
| 1510B       | 1000  | 25.0   | 18.0  | 1.0  | 25    | 1.1                                  | 3.0  | 150   | 25  | 3000   | 2.0                                   |
| 1502FB      | 200   | 25.0   | 18.0  | 1.0  | 25    | 1.2                                  | 3.0  | 150   | 25  | 150  | 2.0                                   |
| 1506FB      | 600   | 25.0   | 18.0  | 1.0  | 25    | 1.5                                  | 3.0  | 150   | 25  | 150  | 2.0                                   |
| 1510FB      | 1000  | 25.0   | 18.0  | 1.0  | 25    | 1.5                                  | 3.0  | 150   | 25  | 150  | 2.0                                   |
| 1502UFB     | 200   | 22.0   | 13.0  | 1.0  | 25    | 1.7                                  | 3.0  | 150   | 25  | 70   | 2.0                                   |
| 1506UFB     | 600   | 22.0   | 13.0  | 1.0  | 25    | 1.7                                  | 3.0  | 150   | 25  | 70   | 2.0                                   |
| 1510UFB     | 1000  | 22.0   | 13.0  | 1.0  | 25    | 1.7                                  | 3.0  | 150   | 25  | 70   | 2.0                                   |

(1)T<sub>rr</sub> Testing: I<sub>f</sub>=0.5A, I<sub>r</sub>=1.0A, I<sub>rr</sub>=0.25A \*Op. Temp. & Stg. Temp. = -55°C to +150°C Isolation Voltage: 2000V

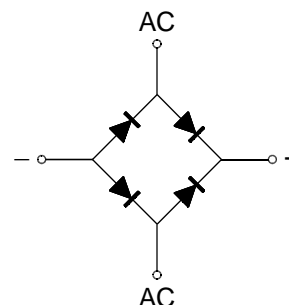
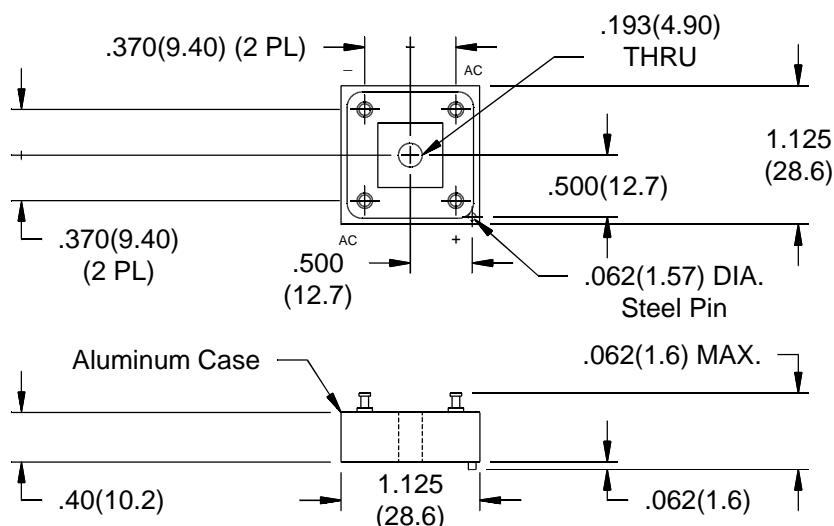

Dimensions: In. (mm) • All temperatures are ambient unless otherwise noted. • Data subject to change without notice.



**VOLTAGE MULTIPLIERS INC.**  
8711 W. Roosevelt Ave.  
Visalia, CA 93291

TEL 559-651-1402  
FAX 559-651-0740  
www.voltagemultipliers.com

# 1502B - 1510B • 1502FB - 1510FB • 1502UFB - 1510UFB

