

UNCONTROLLED DOCUMENT

PART NUMBER
GT-CM3350LREV.
B

REV.	E.C.N. NUMBER AND REVISION COMMENTS	DATE
A	E.C.N. #10BRDR. & REDRAWN.	3-28-00
B	E.C.N. #10BRDR. & 10912.	9.23.02

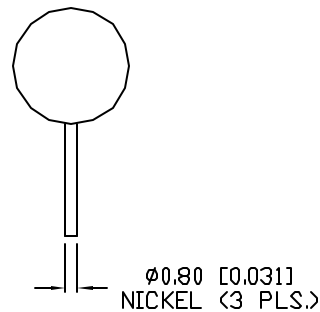
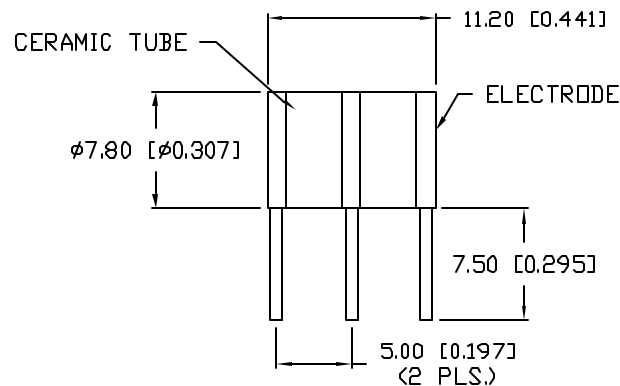

ELECTRICAL SPECIFICATIONS

PARAMETER	VALUE	TEST CONDITION
D.C. FIRING VOLTAGE:	350V \pm 20% D.C.	(dv/dt 100V/S)
IMPULSE FIRING VOLTAGE:	600V D.C. MAX.	(dv/dt 100V/ μ S)
IMPULSE CURRENT:	10KA MAX.	(8/20 μ S)
D.C. HOLDOVER VOLTAGE:	150V D.C. MAX.	(10/1000 μ S 500A)
A.C. DISCHARGE CURRENT:	65A	(50Hz, 9 CYCLES)
INSULATION RESISTANCE:	10 ⁴ M Ω MIN.	(50 OR 100VDC)
INTER-ELECTRODE CAPACITANCE:	2.0 PF MAX.	1.0KHz

ENVIRONMENTAL SPECIFICATIONS PER MIL-STD 202

TEST	METHODE	CONDITION	RATING
VIBRATION TESTING:	204B	C	10-55HZ, 0.6DA
SHOCK	213A	C	100G
HUMIDITY:	103B	B	95%RH, HUMIDITY
TEMPERATURE CYCLING:	102A	C	-65 TO +125 °C
BAROMETRIC PRESSURE:	105C	B	50,000FT.
THERMAL SHOCK:	107	B	-65 TO +125 °C
SOLDERABILITY:	208	B	

RESPONSE TIME

SURGE TYPE	(Rt MAX.)
1Kv/mS	1 x 10 ⁻⁵ sec.
1Kv/ μ S	1 x 10 ⁻⁸ sec.
5Kv/ μ S	1 x 10 ⁻⁹ sec.

UNCONTROLLED DOCUMENT

*UNLESS OTHERWISE SPECIFIED TOLERANCES PER DECIMAL PRECISION ARE: X=1 (10.039), X.X=0.5 (0.020), X.XX=0.25 (0.010), X.XXX=0.127 (0.005). LEAD SIZE=0.05 (0.002), LEAD LENGTH=0.75 (0.030), MIN. +DECIMAL PRECISION MAX.= +0.00 -0.00

REV.
BPART NUMBER
GT-CM3350L

CONFIDENTIAL INFORMATION
THE INFORMATION CONTAINED IN THIS DOCUMENT IS THE PROPERTY OF LUMEX INC. EXCEPT AS SPECIFICALLY AUTHORIZED IN WRITING BY LUMEX INC., THE HOLDER OF THIS DOCUMENT SHALL KEEP ALL INFORMATION CONTAINED HEREIN CONFIDENTIAL AND SHALL PROTECT SAME IN WHOLE OR IN PART FROM DISCLOSURE AND DISSEMINATION TO ALL THIRD PARTIES.



290 E. HELEN ROAD
PALATINE, IL 60067-6976
PHONE: +1.847.359.2790
US WEB: www.lumex.com
TW WEB: www.lumex.com.tw

CERAMIC ARRESTOR, 3 LEADED (350 VDC).

RELIABILITY NOTE
OUR MANY YEARS OF EXPERIENCE DATA ACCUMULATION INDICATE THAT SOLDER HEAT IS A MAJOR CAUSE OF EARLY AND FUTURE FAILURE. PLEASE PAY ATTENTION TO YOUR SOLDERING PROCESS.

DRAWN BY:

SK

CHECKED BY:

APPROVED BY:

DATE: 8.5.93

PAGE: 1 OF 1

SCALE: N/A