

## Holder / No. 570

## Panel Mount, for TR5®/TE5® Fuses

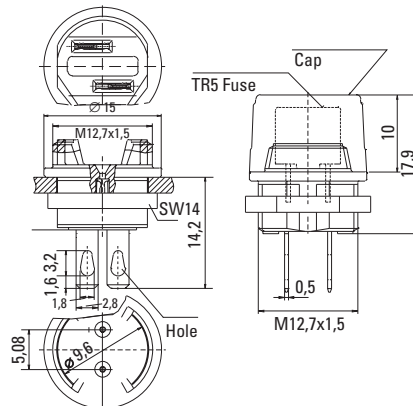

with cap 575 IP40  
(only on front side)

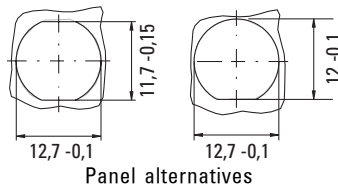

## Specifications

### Packaging

000 bulk (100 pcs.)

### Order Number

Holder No. 570 0000 000

### Mounting

12.7mm diameter D-hole or double D-hole  
Admissible torque on plastic hex nut is 1.2Nm

### Terminals

Solderable or 2.8mm quick connect-fits 0.5mm tab

### Materials

Holder: Black Thermoplastic, UL 94 V-0  
Polyamide PA 6.6

Metal parts: Copper alloy  
Solderable tinned

### Electrical Data (23°C/without Cap)

Rated Voltage: 250V  
Max. Current/Power: 6.3A/2.5W

### Minimum Cross Section

Conductor - 2.5mm<sup>2</sup>

### Unit Weight

2.2g

### Order Information

Qty.	Order-Number	Series		Packaging
		570	0000	000

Specifications are subject to change without notice

## Cap / No. 575

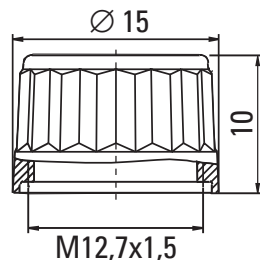

### Packaging

000 bulk (100 pcs.)

### Order Number

Cap No. 575 0000 000

### Plastic Cap

Use with No. 570 or No. 571

### Materials

Cap: Transparent Thermoplastic  
Polycarbonat PC, UL94 V-0

### Unit Weight

0.94g

### Order Information

Qty.	Order-Number	Series		Packaging
		575	0000	000

Specifications are subject to change without notice

## Holder / No. 571

## PC Mount, for TR5®/TE5® Fuses



### Holes in PCB

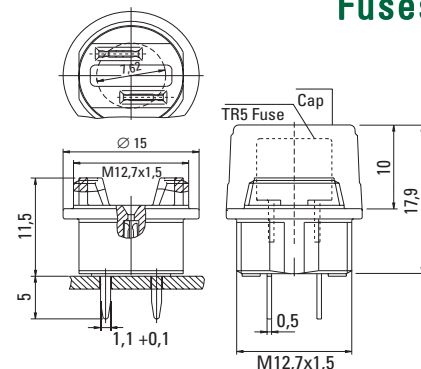
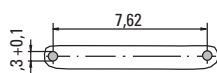

### Packaging

000 bulk (100 pcs.)

### Order Number

Holder No. 571 0000 000

### Mounting

PC Board, 7.62mm hole spacing

### Materials

Holder: Black Thermoplastic, UL94 V-0  
Polyamide PA 6.6

Metal parts: Copper alloy  
Solderable, tinned

### Electrical Data (23°C/without Cap)

Rated Voltage: 250V  
Max. Current/Power: 6.3A/2.5W

### Minimum Cross Section

Conducting path - 0.2mm<sup>2</sup>

### Unit Weight

1.6g

### Order Information

Qty.	Order-Number	Series		Packaging
		571	0000	000

Specifications are subject to change without notice

Note: 1.00 means the number one with two decimal places. 1,000 means the number one thousand.