

Ledtech DOT MATRIX DISPLAY

2.0" 4X4 BI-COLOR Electrical/Optical Characteristics at T_A=25°C & I_F=20mA

PART NUMBER	CHIP COLOR		λ p(nm)		V _F (V)				I _V (mcd)	
			TYP.	TYP.	TYP.	MAX.	TYP.	MAX.	TYP.	TYP.
LJ216X-OGEWEW	ORANGE	GREEN	630	572	4.2	4.8	4.2	4.8	17.6	15.3
LJ216X-M1FEWEW	RED	HE GREEN	660	572	3.4	4.4	4.2	4.8	41.1	41.1
LJ216X-SBFEWEW	SB RED	HE GREEN	660	572	3.4	4.4	4.2	4.8	68.4	41.1

※ (X : DIFFERENT CIRCUIT)

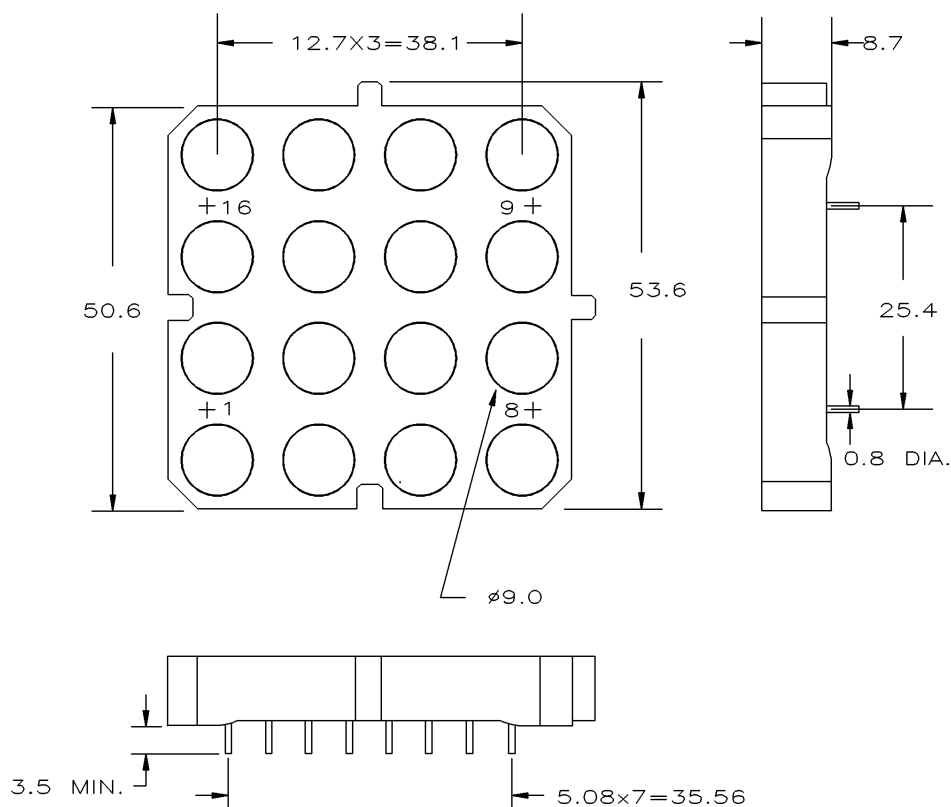

PIN FUNCTION

LJ 2165-XX BI-COLOR CATHODE ROW

ROW NO. (CATHODE)	1	2	3	4
PIN NO. (GREEN)	9	11	13	15
PIN NO. (RED or ORANGE)	10	12	14	16
COLUMN NO. (ANODE)	1	2	3	4
PIN NO. (GREEN)	1	3	5	7
PIN NO. (RED or ORANGE)	2	4	6	8

LJ 2166-XX BI-COLOR ANODE ROW

ROW NO. (ANODE)	1	2	3	4
PIN NO. (GREEN)	9	11	13	15
PIN NO. (RED or ORANGE)	10	12	14	16
COLUMN NO. (CATHODE)	1	2	3	4
PIN NO. (GREEN)	1	3	5	7
PIN NO. (RED or ORANGE)	2	4	6	8

NOTES : 1.ALL DIMENSIONS ARE IN mm, TOLERANCE IS ±0.25mm UNLESS OTHERWISE NOTED.
2.THE SLOPE ANGLE OF ANY PIN MAY BE ±5.0° MAX.