

# Ledtech ALPHANUMERIC DISPLAY

## 0.8" SINGLE ALPHANUMERIC DISPLAY Electrical/Optical Characteristics at T<sub>A</sub>=25°C & I<sub>F</sub>=20mA

PART NUMBER	CHIP COLOR	λ <sub>p</sub> (nm)	V <sub>F</sub> (V)		I <sub>V</sub> (mcd)	
COMMON ANODE (COMMON CATHODE)			TYP.	MAX.	MIN.	TYP.
LA(C)8021-11BEWRN	GREEN	572	2.1	2.4	4.5	7.4
LA(C)8031-11BEWRN	YELLOW	589	2.1	2.4	3.7	6.1
LA(C)8041-11BEWRN	ORANGE	630	2.1	2.4	5.1	8.6
LA(C)8041R-11BRRRN	ORANGE	630	2.1	2.4	5.1	8.6
LA(C)8051-11BEWRN	RED	700	2.1	2.4	1.4	2.3

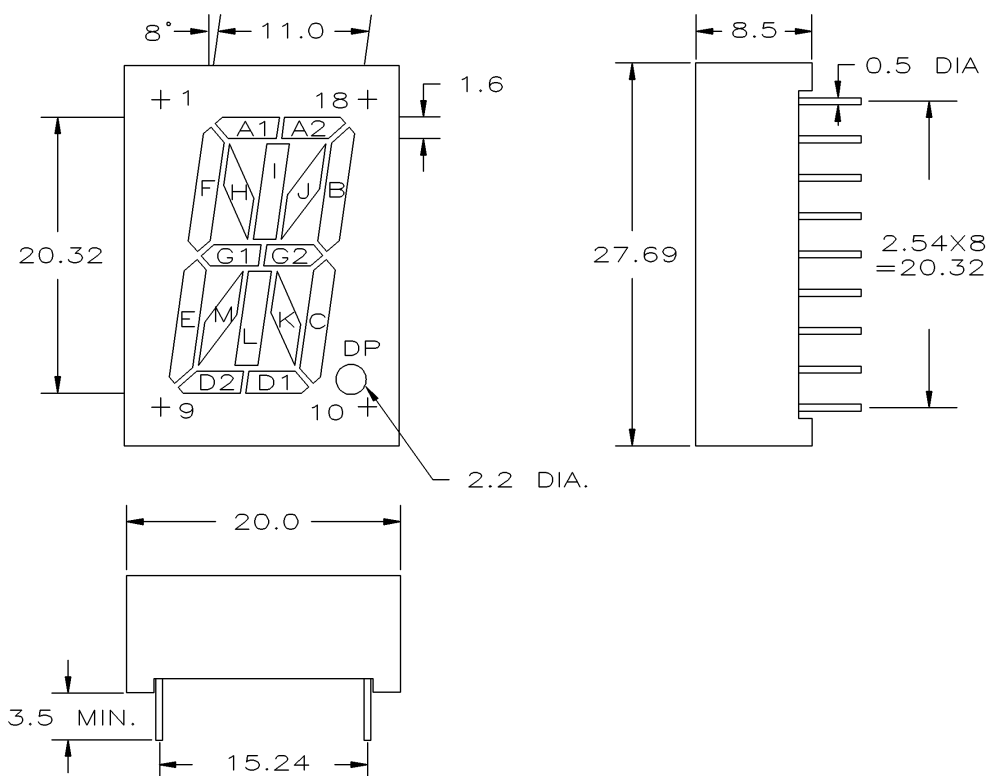

**LA80X1-11B  
COMMON ANODE**

PIN NO.	FUNCTION	PIN NO.	FUNCTION
1. CATHODE	A2	10. CATHODE	D1
2. CATHODE	A1	11. CATHODE	D2
3. CATHODE	F	12. COMMON	ANODE
4. CATHODE	H	13. CATHODE	C
5. CATHODE	E	14. CATHODE	G1
6. CATHODE	I	15. CATHODE	B
7. CATHODE	L	16. CATHODE	G2
8. CATHODE	M	17. COMMON	ANODE
9. CATHODE	K	18. CATHODE	J

**LC80X1-11B  
COMMON CATHODE**

PIN NO.	FUNCTION	PIN NO.	FUNCTION
1. ANODE	A2	10. ANODE	D1
2. ANODE	A1	11. ANODE	D2
3. ANODE	F	12. COMMON	CATHODE
4. ANODE	H	13. ANODE	C
5. ANODE	E	14. ANODE	G1
6. ANODE	I	15. ANODE	B
7. ANODE	L	16. ANODE	G2
8. ANODE	M	17. COMMON	CATHODE
9. ANODE	K	18. ANODE	J