



EVERLIGHT ELECTRONICS CO.,LTD.

Device Number : CDLE-125-016 REV.: 2

3.0mm Multi-Color Round Type LED Lamps

PART NO. : 1259-7HGW

ECN : _____ Page: 1/5

■ Features :

- Two chips are matched for uniform light output, wide viewing angle
- Long life-solid state reliability
- I.C. compatible/Low power consumption

■ Descriptions :

The 1259-7 LED lamp contain two integral chips and is available as both bicolor and bipolar types.

- The Bright Red and Green light is emitted by diodes of GaP and GaP respectively.
- Type of bipolar lamps are both White Diffused and Color Diffused while the bicolor are White Diffused

■ Applications :

- TV set
- Monitor
- Telephone
- Computer

■ Package Dimensions:

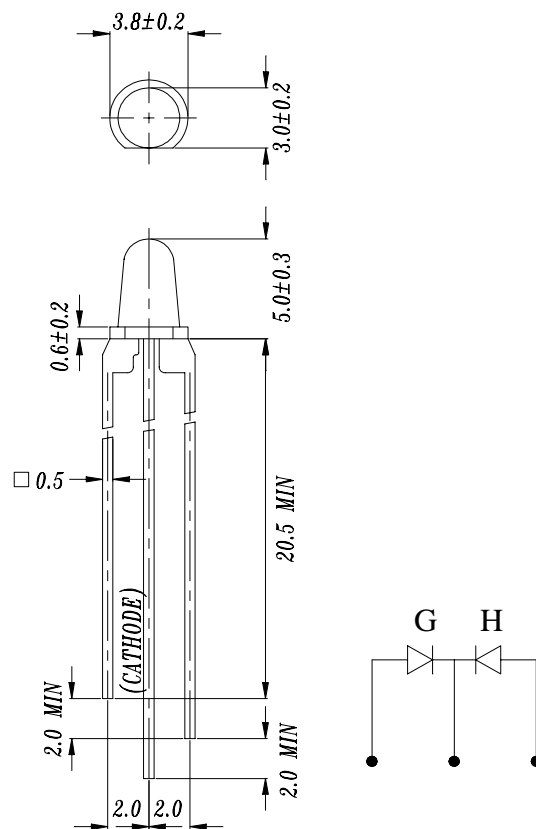

■ Notes :

1. All dimensions are in millimeters.
2. An epoxy meniscus may extend about 1.5mm(0.059") down to the lead.
3. Tolerances unless Dimension ± 0.25 mm.

PART NO.	Chip		Lens Color
	Material	Emitted Color	
1259-7HGW	GaP	Bright Red	White Diffused
	GaP	Green	

Office : 7C Building, Lian Hua Port Industrial District, Lian Hua Shan

Bonded Pricessing Zone Pan Yu, Guang Zhou, China

TEL. : (020)84860913,84860914

FAX : (020)84860600

[http : //www.everlight.com](http://www.everlight.com)

#N/A



EVERLIGHT ELECTRONICS CO.,LTD.

Device Number : CDLE-125-016 REV.: 2

3.0mm Multi-Color Round Type LED Lamps

PART NO. : 1259-7HGW ECN : Page: 2/5

■ Absolute Maximum Ratings at Ta = 25°C

Parameter	Symbol	Rating	Unit
Forward Current	IF	H 15	mA
		VG 30	
Operating Temperature	Topr	-40 to +85	°C
Storage Temperature	Tstg	-40 to +100	°C
Soldering Temperature	Tsol	260 ± 5	°C
Power Dissipation	Pd	H 45	mW
		VG 100	
Peak Forward Current (Duty 1/10 @ 1KHz)	IF(Peak)	H 50	mA
		VG 160	
Reverse Voltage	VR	5	V

■ Electronic Optical Characteristics :

Parameter	Symbol	Min.	Typ.	Max.	Unit	Condition
Luminous Intensity	Iv H	0.4	0.8	/	mcd	IF= 10 mA
	VG	2.5	10	/		
Viewing Angle	2 θ 1/2	/	60	/	deg	IF= 20 mA
Peak Wavelength	λ p H	/	697	/	nm	IF= 10 mA
	VG	/	570	/		IF= 20 mA
Dominant Wavelength	λ d H	/	650	/	nm	IF= 10 mA
	VG	/	571	/		IF= 20 mA
Spectrum Radiation Bandwidth	△ λ H	/	90	/	nm	IF= 10 mA
	VG	/	30	/		IF= 20 mA
Forward Voltage	VF H	1.5	2.0	2.4	V	IF= 10 mA
		VG	1.7	2.1		IF= 20 mA
Reverse Current	IR	/	/	10	μ A	VR= 5 V



EVERLIGHT ELECTRONICS CO.,LTD.

Device Number : CDLE-125-016 REV.: 2

3.0mm Multi-Color Round Type LED Lamps

PART NO. : 1259-7HGW ECN : Page: 3/5

■ Typical Electro-Optical Characteristic Curves:

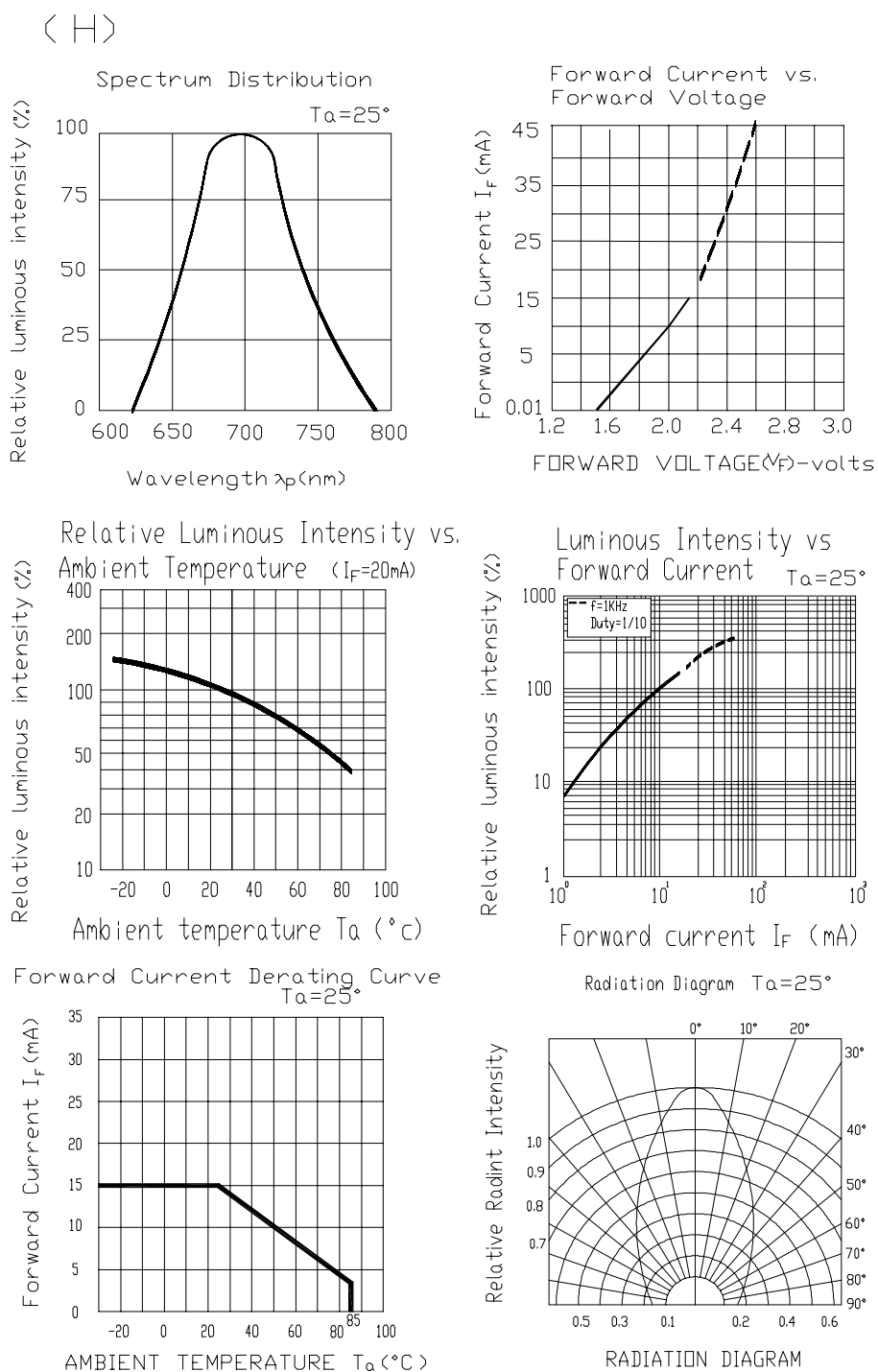



EVERLIGHT ELECTRONICS CO.,LTD.

Device Number : CDLE-125-016 REV.: 2

3.0mm Multi-Color Round Type LED Lamps

PART NO. 1259-7HGW ECN : Page: 4/5

■ Typical Electro-Optical Characteristic Curves:

G

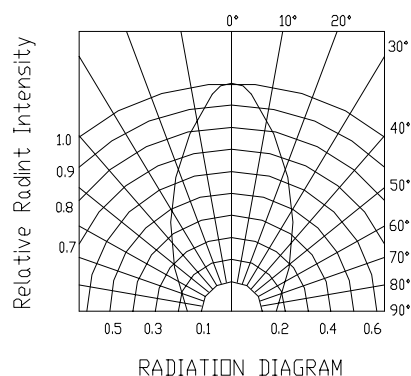
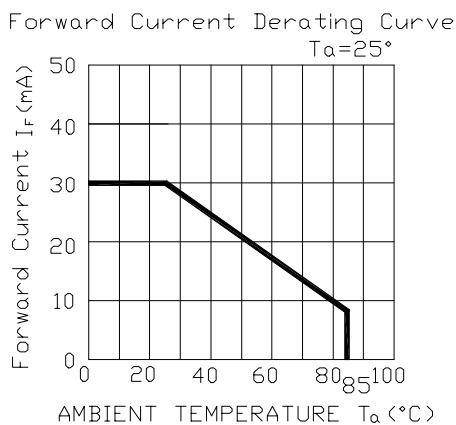
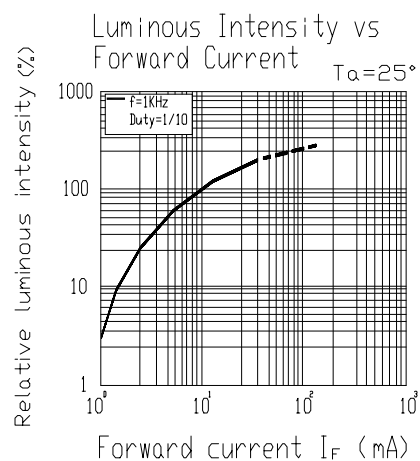
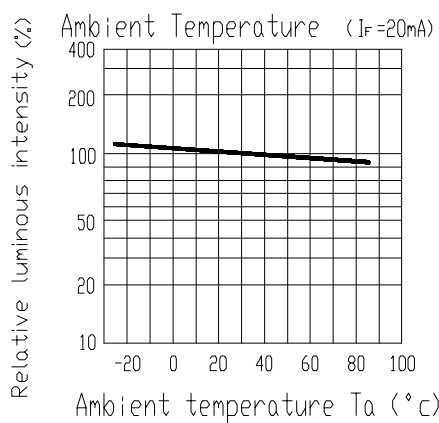
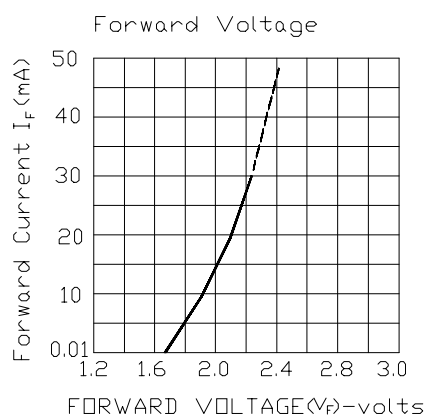
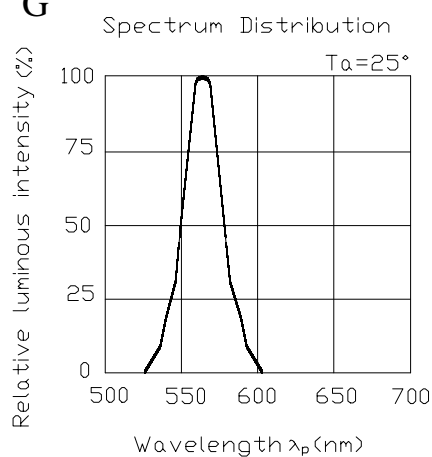



EVERLIGHT ELECTRONICS CO.,LTD.

Device Number : CDLE-125-016 REV.: 2

3.0mm Multi-Color Round Type LED Lamps

PART NO. : 1259-7HGW ECN : Page: 5/5

■ Reliability test items and conditions:

NO	Item	Test Conditions	Test Hours/Cycle	Sample Size	Ac/Re
1	Solder Heat	TEMP:260°C± 5°C	5 SEC	76 PCS	0/1
2	Temperature Cycle	H : +85°C 30min └ 5 min L : -55°C 30min	50 CYCLES	76 PCS	0/1
3	Thermal Shock	H : +100°C 5min └ 10 sec CDAE-069-027	50 CYCLES	76 PCS	0/1
4	High Temperature Storage	TEMP : 100°C	1000 HRS	76 PCS	0/1
5	Low Temperature Storage	TEMP : -55°C	1000 HRS	76 PCS	0/1
6	DC Operating Life	TEMP : 25°C H: I _F =10 mA;G: I _F =20 mA	1000 HRS	76 PCS	0/1
7	High Temperature / High Humidity	85°C / 85% RH	1000 HRS	76 PCS	0/1